

BYOD – Using Intel® Education Study on Your Android Device

Note: Please be sure your device meets the minimum specifications as listed on the MDCPS Bring Your Own Device (BYOD) page - http://wifi.dadeschools.net/minimum_specs.asp

1. If not already installed, install the Intel® Education Study App from the Google Play Store
 - a. Link: <https://play.google.com/store/apps/details?id=com.kno.textbooks&hl=en>
2. After installing the app, open the app on the device
3. Select the Sign In button

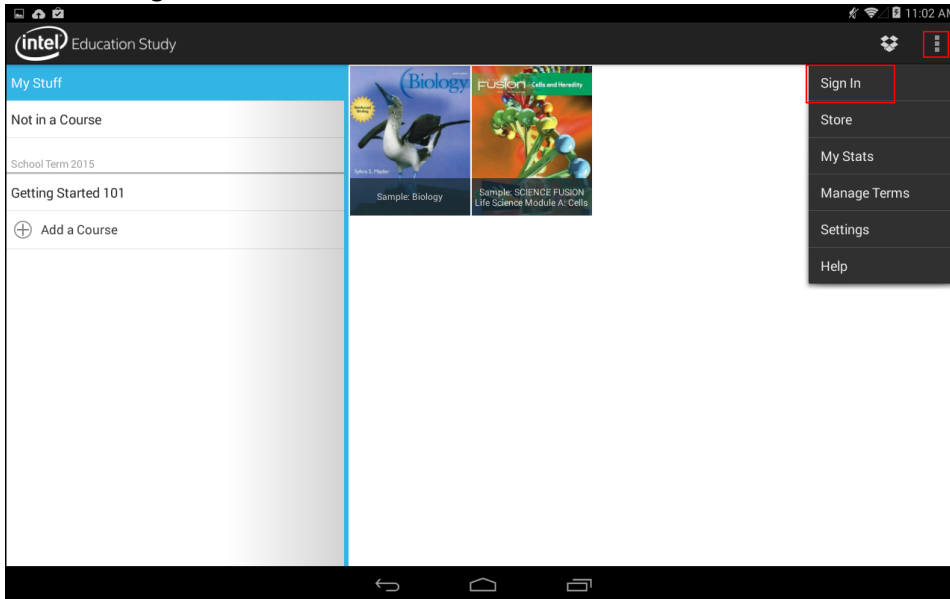

4. On the sign in page, select “Sign in with Clever”

A screenshot of the Intel Education Study sign-in page. The page title is 'Sign In'. Below the title, there is a description: 'Signing in allows you to access Publisher Bookshelf, Claim eBook, Join Collections, and to see all your previous purchases/content.' To the right of this text is a link: 'Don't have an account? Register'. There are two input fields: one for an email address (containing 'john.smith@example.edu') and one for a password (containing 'Password'). Below the password field is a link: 'Forgot your password?'. There is a checkbox with the text 'I agree to Terms of Service and EULA'. At the bottom, there are two buttons: 'Sign In' and 'Cancel'. A red rectangular box highlights the text 'Want to use your school credentials? Sign in with Clever' located at the bottom left of the page.

5. On the Clever Instant Login page, search the name of your school
 - a. Once the institution is found, select it
 - b. After selecting your school, select “Log in with Active Directory”

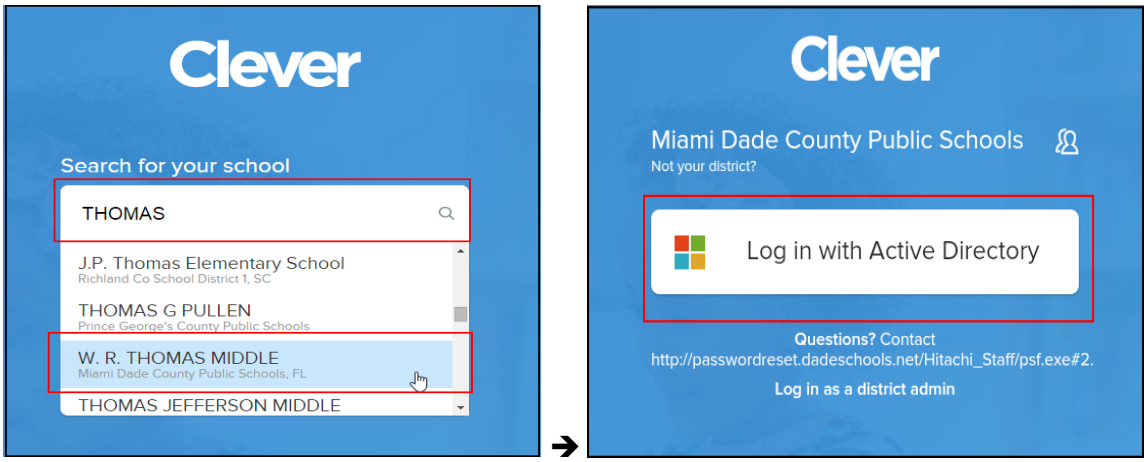

6. Enter your Active Directory credentials and select “Sign In”

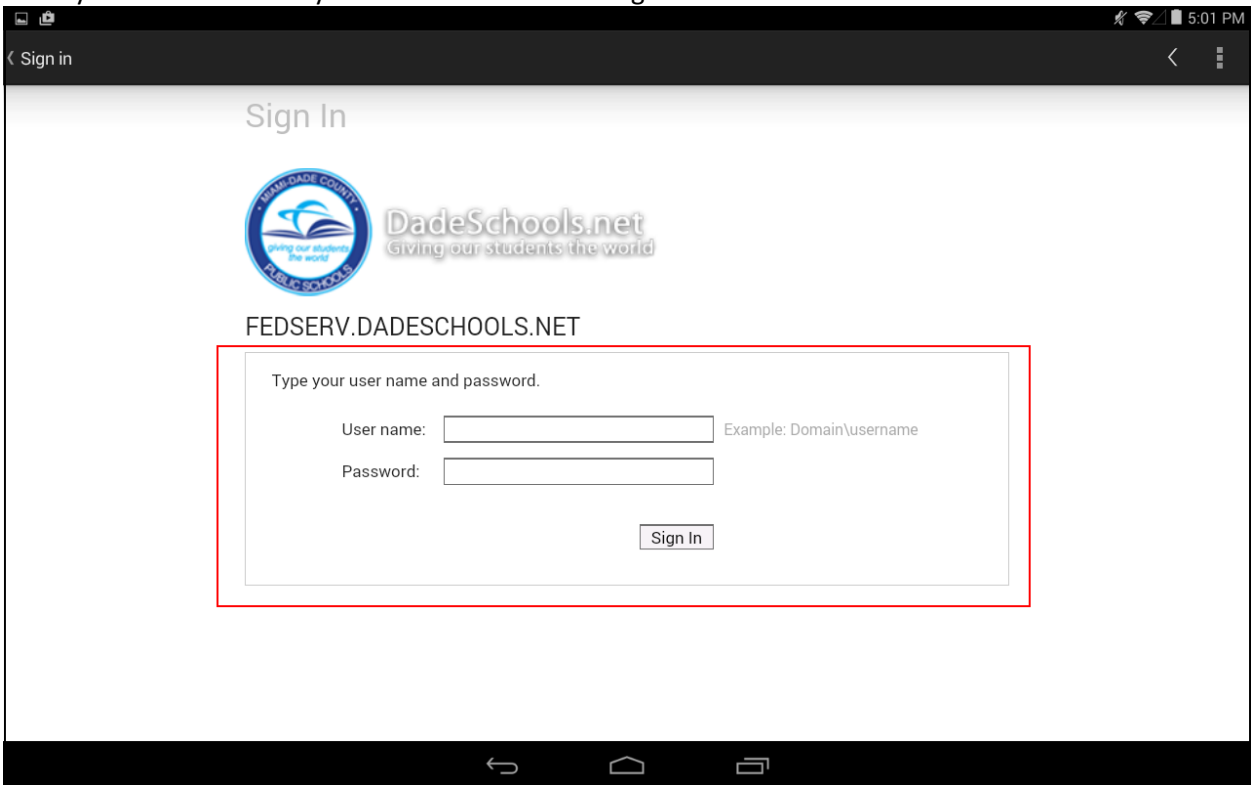

7. After entering your AD credentials, you will be taken back to the Course Manager and should see a confirmation message stating “Signed in successfully”.

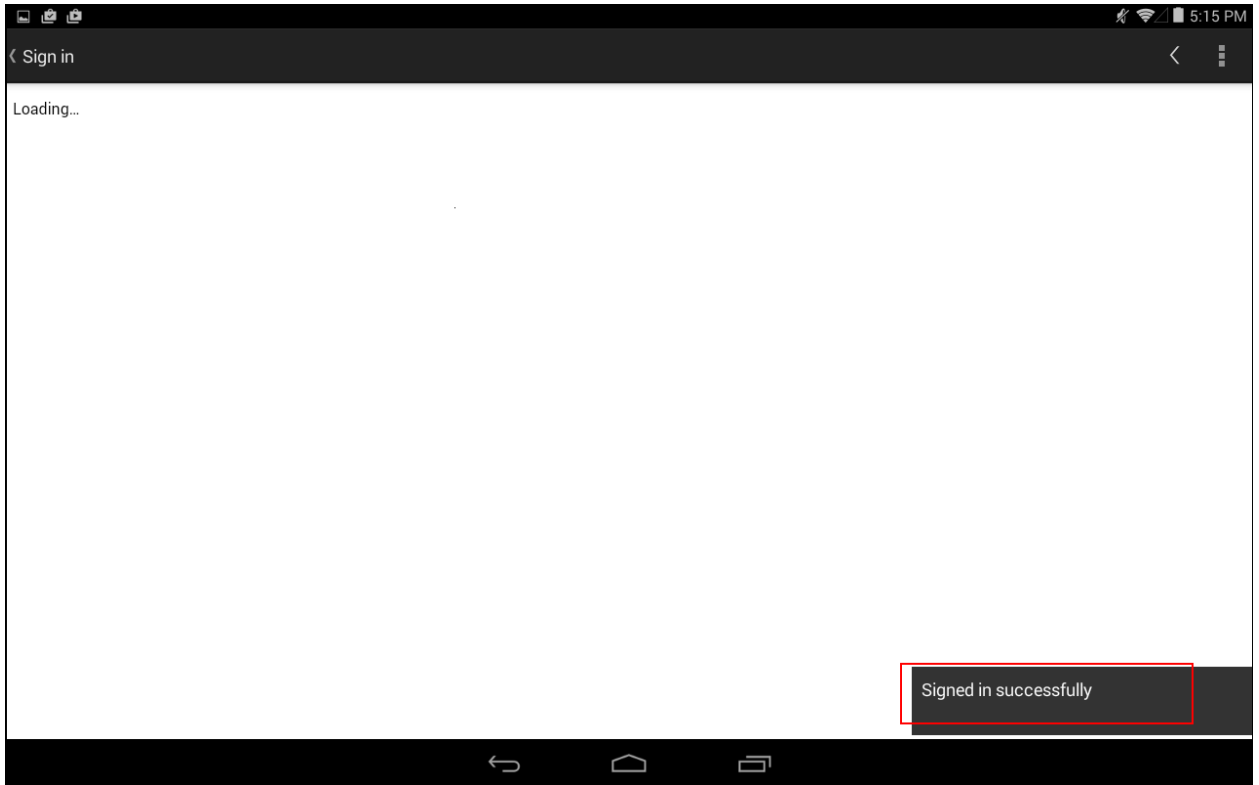

8. From there, the eTextbooks associated with your account will begin to populate within your Course Manager with "Tap to Download" displayed across the cover